

RUGBY®

Architectural Building Products

NEW *FOR
2021*

***MOUNTAIN & PACIFIC NORTHWEST
REGION***

BOISE • DENVER • LAS VEGAS • PORTLAND • SALT LAKE CITY

***CABINET PRODUCT
CATALOG***

FIND OUT INSIDE

Table of Contents

Cabinet Lines	Page 04
Product Comparison	Page 15
Product Specifications	Page 17
- Wall Cabinets	Page 18
- Base Cabinets	Page 21
- Tall Cabinets	Page 23
- Vanity Cabinets	Page 24
- Mouldings & Trim	Page 26
- Fillers & Panels	Page 27
- Accessories	Page 28
Decorative Hardware	Page 30
Products By Line	Page 33



CABINET LINES

Our **Premier Series** offers distinctive touches and superb craftsmanship, satisfying either the traditional or modern design palette with a look to fit any lifestyle. The classic cabinets in our **Value Series** are perfect for any space offering functionality and style at a budget-friendly price.



Premier Series

					
SHAKER SAND (SS)	SHAKER DESIGNER WHITE SLAB (SWS)	SHAKER DESIGNER WHITE 5PC (SW)	SHAKER ESPRESSO (SE)	BROOKLYN MODERN GRAY (BG)	BROOKLYN SLATE (BS)

Value Series

					
BROOKLYN BRIGHT WHITE (BW)	NAPA WHITE (NW)	LENOX COUNTRY LINEN (LL)	LENOX CANVAS (LV)	TAYLOR ESPRESSO (TE)	TAYLOR WHITE (TW)

Our Vision

We provide thoughtful products and exceptional service to inspire spaces where people love to live.

Shaker

Bright, crisp, and modern, this cabinet has a versatile appeal. The design incorporates the architectural shaker style with pleasing proportions. Shaker White is available with a slab or 5-piece drawer front yielding a contemporary or classic display.

- Full overlay doors provide a seamless aesthetic
- Soft-close doors and drawers prevent slamming
- Dovetail drawer craftsman construction
- Full extension drawers ensure easy access
- Durable solid wood cabinet box and drawers
- Premium Sherwin-Williams® finish delivers a lifetime of beauty
- Full line of accessories and upgrades available

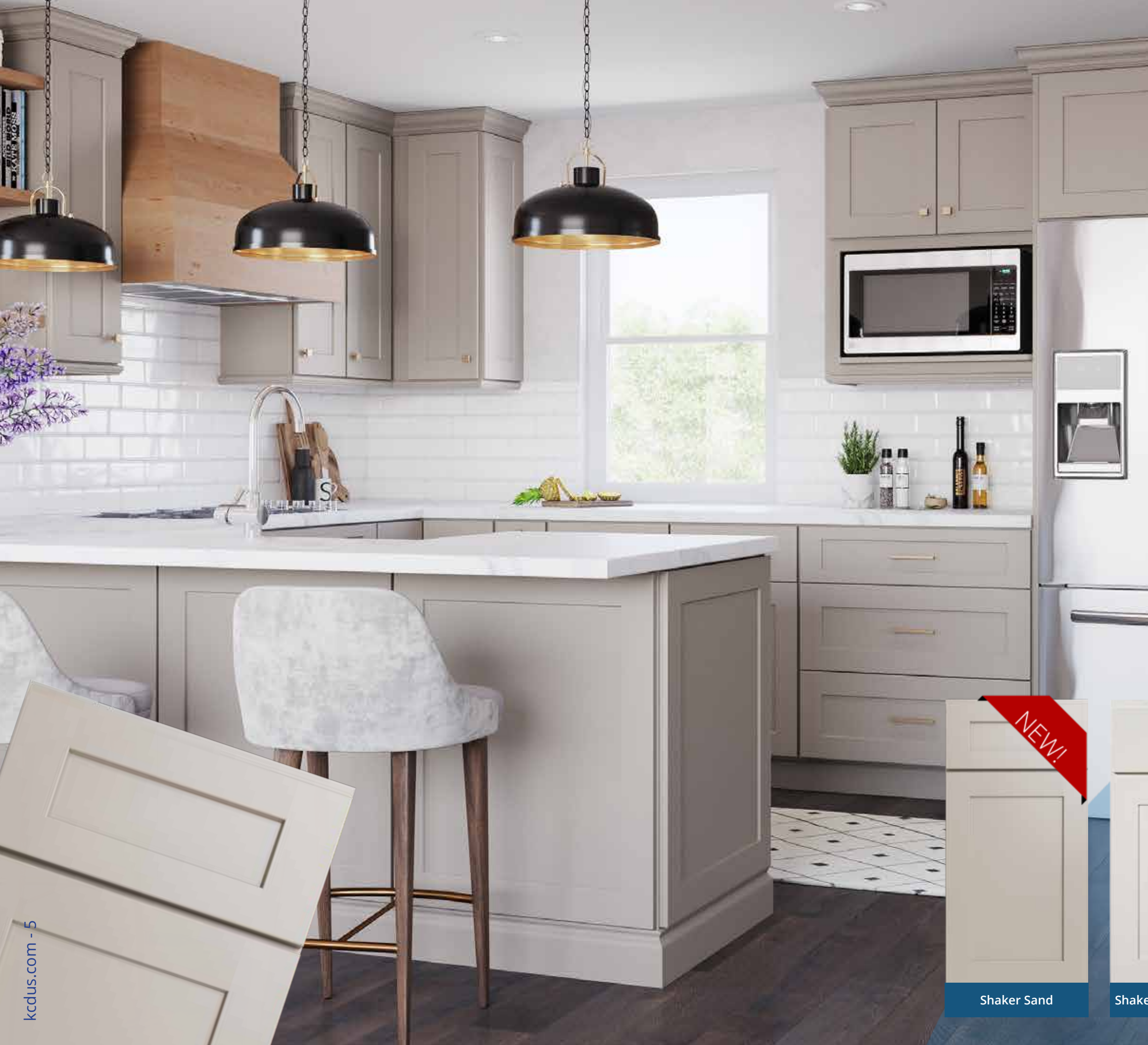

Shaker Sand



Shaker Designer White



Shaker Designer White



Shaker Espresso

*Slab

*5 Piece

Brooklyn

This transitional door complements a range of style from modern to vintage to traditional. The selection of color options within the Brooklyn line offers a solution for many design needs. Find modern charm in Brooklyn Gray or install a Slate island for the perfect kitchen accent that your guests will love. Brooklyn's classic Bright White finish provides a timeless backdrop for a space that will become a gathering sport for years to come.

- Full overlay doors provide a seamless aesthetic
- Soft-close doors and drawers prevent slamming
- Dovetail drawer craftsman construction
- Full extension drawers ensure easy access
- Solid wood cabinet box and drawers provide exceptional durability
- Premium Sherwin-Williams® finish delivers a lifetime of beauty
- Available with a full line of accessories and upgrades



Brooklyn Bright White



Brooklyn Modern Grey



Brooklyn Slate

Napa

The Napa White line is an adaptable option that adds dimension and elegance. The bright white finish and raised center panel provide a charming and traditional feel that is perfect for any home.

- Full overlay doors provide a seamless aesthetic
- Soft-close doors and drawers prevent slamming
- Dovetail drawer craftsman construction
- Full extension drawers ensure easy access
- Solid wood cabinet box and drawers provide exceptional durability
- Sherwin-Williams® finish delivers a lifetime of beauty
- Available with a full line of accessories and upgrades that add style and function



Napa White

Lenox

This elegant painted door style is constructed from solid wood with applied moulding. The hand brushed glaze lines on Country Linen add an element of detail that conveys warmth and charm.

- Full overlay doors provide a seamless aesthetic
- Soft-close doors and drawers prevent slamming
- Dovetail drawer craftsman construction
- Full extension drawers ensure easy access
- Solid wood cabinet box and drawers provide exceptional durability
- Premium Sherwin-Williams® finish delivers a lifetime of beauty
- Available with a full line of accessories and upgrades that add style and function



Lenox Canvas



Lenox Country Linen

Taylor

Our Taylor line provides style, function, and full overlay, soft-close doors at a price point that's easy on your wallet. Blending traditional and contemporary. Taylor creates a classic and clean look that will endure for years to come.

- Full overlay doors provide a seamless aesthetic
- Plywood back panel
- Premium Sherwin-Williams® finish
- Soft-close doors prevent slamming
- Optional dovetail, soft-close, full extension drawer upgrade available



Taylor White



Taylor Espresso



	Shaker Sand	Shaker Espresso	Shaker Designer White	Brooklyn Modern Gray	Brooklyn Bright White	Brooklyn Slate	Lenox Country Linen	Lenox Canvas	Napa White
Cabinet Box	1/2", 7 Ply, Plywood	1/2", 7 Ply, Plywood	1/2", 7 Ply, Plywood	1/2", 7 Ply, Plywood	1/2", 7 Ply, Plywood	1/2", 7 Ply, Plywood	1/2", 7 Ply, Plywood	1/2", 7 Ply, Plywood	1/2", 7 Ply, Plywood
Drawer Box	5/8" Solid Wood, Dovetailed	5/8" Solid Wood, Dovetailed	5/8" Solid Wood, Dovetailed	5/8" Solid Wood, Dovetailed	5/8" Solid Wood, Dovetailed	5/8" Solid Wood, Dovetailed	5/8" Solid Wood, Dovetailed	5/8" Solid Wood, Dovetailed	5/8" Solid Wood, Dovetailed
Drawer Slides	Under Mount, Full Extension, Metal, Soft Close w/ Ball Bearings	Under Mount, Full Extension, Metal, Soft Close w/ Ball Bearings	Under Mount, Full Extension, Metal, Soft Close w/ Ball Bearings	Under Mount, Full Extension, Metal, Soft Close w/ Ball Bearings	Under Mount, Full Extension, Metal, Soft Close w/ Ball Bearings	Under Mount, Full Extension, Metal, Soft Close w/ Ball Bearings	Under Mount, Full Extension, Metal, Soft Close w/ Ball Bearings	Under Mount, Full Extension, Metal, Soft Close w/ Ball Bearings	Under Mount, Full Extension, Metal, Soft Close w/ Ball Bearings
Wood Species	Birch	Birch	Birch	Birch	Birch	Birch	Birch	Birch	Birch
Door Hinge	DTC 6 Way Adjustable, Soft Close	DTC 6 Way Adjustable, Soft Close	DTC 6 Way Adjustable, Soft Close	DTC 6 Way Adjustable, Soft Close	DTC 6 Way Adjustable, Soft Close	DTC 6 Way Adjustable, Soft Close	DTC 6 Way Adjustable, Soft Close	DTC 6 Way Adjustable, Soft Close	DTC 6 Way Adjustable, Soft Close
Shelves	Adjustable, 3/4" Plywood	Adjustable, 3/4" Plywood	Adjustable, 3/4" Plywood	Adjustable, 3/4" Plywood	Adjustable, 3/4" Plywood	Adjustable, 3/4" Plywood	Adjustable, 3/4" Plywood	Adjustable, 3/4" Plywood	Adjustable, 3/4" Plywood
Finish Color	Sand	Espresso Stain	Designer White	Modern Gray	Bright White	Slate Stain	Country Linen	Canvas	Bright White
Exterior Finish	Sand to Match Doors	Espresso to Match Doors	Designer White to Match Doors	Modern Gray to Match Doors	Bright White to Match Doors	Slate to Match Doors	Country Linen to Match Doors	Canvas to Match Doors	Bright White to Match Doors
Interior Finish	Natural	Natural	Natural	Natural	Natural	Natural	Natural	Natural	Natural
Glazing	No	No	No	No	No	No	Yes, Brown Lines	No	No
Base Reinforcement	3" Plywood Stretchers	3" Plywood Stretchers	3" Plywood Stretchers	3" Plywood Stretchers	3" Plywood Stretchers	3" Plywood Stretchers	3" Plywood Stretchers	3" Plywood Stretchers	3" Plywood Stretchers
Face Frame	1 1/2" Rails and Stiles, Solid Wood	1 1/2" Rails and Stiles, Solid Wood	1 1/2" Rails and Stiles, Solid Wood	1 1/2" Rails and Stiles, Solid Wood	1 1/2" Rails and Stiles, Solid Wood	1 1/2" Rails and Stiles, Solid Wood	1 1/2" Rails and Stiles, Solid Wood	1 1/2" Rails and Stiles, Solid Wood	1 1/2" Rails and Stiles, Solid Wood
Full Overlay Door	5-Piece with Solid Center Panel; 3 1/2" Stiles and Rails	5-Piece with Solid Center Panel; 3 1/2" Stiles and Rails	5-Piece with Solid Center Panel; 3 1/2" Stiles and Rails	5-Piece with Solid Center Panel; 3 1/2" Stiles and Rails	5-Piece with Solid Center Panel; 3 1/2" Stiles and Rails	5-Piece with Solid Center Panel; 3 1/2" Stiles and Rails	9-Piece Raised Panel with Applied Moulding	9-Piece Raised Panel with Applied Moulding	5-Piece with Solid Center Panel; 3 1/2" Stiles and Rails
Drawer Head	5 Piece with Solid Center Panel; 2 3/4" Stiles and 2 3/4" Rails	5 Piece with Solid Center Panel; 2 3/4" Stiles and 2 3/4" Rails	5 Piece with Solid Center Panel; 2 3/4" Stiles and 2 3/4" Rails Also available in slab	5 Piece with Solid Center Panel; 2 3/4" Stiles and 2 3/4" Rails	5 Piece with Solid Center Panel; 2 3/4" Stiles and 2 3/4" Rails	5 Piece with Solid Center Panel; 2 3/4" Stiles and 2 3/4" Rails	9-Piece Raised Panel with Applied Moulding	9-Piece Raised Panel with Applied Moulding	5 Piece with Solid Center Panel; 2 3/4" Stiles and 2 3/4" Rails
Design & Structure	Meets Leading Industry Standards	Meets Leading Industry Standards	Meets Leading Industry Standards	Meets Leading Industry Standards	Meets Leading Industry Standards	Meets Leading Industry Standards	Meets Leading Industry Standards	Meets Leading Industry Standards	Meets Leading Industry Standards
Assembly	Glue and Staples, No Cams or Brackets	Glue and Staples, No Cams or Brackets	Glue and Staples, No Cams or Brackets	Glue and Staples, No Cams or Brackets	Glue and Staples, No Cams or Brackets	Glue and Staples, No Cams or Brackets	Glue and Staples, No Cams or Brackets	Glue and Staples, No Cams or Brackets	Glue and Staples, No Cams or Brackets
Toe Kick Depth w/ TK Skin	3.75"	3.75"	3.75"	3.75"	3.75"	3.75"	3.75"	3.75"	3.75"
Certifications	TSCA VI, CARB, KCMA	TSCA VI, CARB, KCMA	TSCA VI, CARB, KCMA	TSCA VI, CARB, KCMA	TSCA VI, CARB, KCMA	TSCA VI, CARB, KCMA	TSCA VI, CARB, KCMA	TSCA VI, CARB, KCMA	TSCA VI, CARB, KCMA



	Taylor White	Taylor Espresso
Cabinet Box	1/2" Particle Board w/ Plywood Back	1/2" Particle Board w/ Plywood Back
Drawer Box	1/2" Plywood, Straight	1/2" Plywood, Straight
Drawer Slides	Side Mount, 3/4 Extension, Epoxy/Vinyl Slides w/ Nylon Rollers*	Side Mount, 3/4 Extension, Epoxy/Vinyl Slides w/ Nylon Rollers*
Wood Species	Birch	Birch
Door Hinge	DTC 6 Way Adjustable, Soft Close	DTC 6 Way Adjustable, Soft Close
Shelves	Adjustable, 5/8" Plywood	Adjustable, 5/8" Plywood
Finish Color	White	Espresso Stain
Exterior Finish	White to Match Doors	Espresso to Match Doors
Interior Finish	White	Espresso
Glazing	No	No
Base Reinforcement	3/4" Plastic Corner Braces w/ Tabs	3/4" Plastic Corner Braces w/ Tabs
Face Frame	1 1/2" Rails and Stiles, Solid Wood	1 1/2" Rails and Stiles, Solid Wood
Full Overlay Door	5-Piece Recessed Panel	5-Piece Recessed Panel
Drawer Head	Slab	Slab
Design & Structure	Meets Leading Industry Standards	Meets Leading Industry Standards
Assembly	Glue and Staples, No Cams or Brackets	Glue and Staples, No Cams or Brackets
Toe Kick Depth w/ TK Skin	3.75"	3.75"
Certifications	TSCA VI, CARB, KCMA	TSCA VI, CARB, KCMA

**All Value Series drawers can be upgraded. Upgrade includes: Drawer Box (5/8" Dovetailed Solid Wood) Drawer Slides: Undermount, Full Extension, Metal, Soft Close with Ball Bearings. All drawer upgrade SKUs are notated with 'DU' on the order form.*



PRODUCT SPECIFICATIONS

Wall Cabinets - Base Cabinets - Tall Cabinets - Vanity
Cabinets - Mouldings & Trim - Fillers & Panels
Decorative Accessories

CREATIVE OPTIONS FOR ANY SPACE

Wall Cabinet Coding

Standard (12" Deep)

W **30** **36**
CABINET CODE CABINET WIDTH CABINET HEIGHT

Refrigerator

W **36** **18** **24**
CABINET CODE CABINET WIDTH CABINET HEIGHT CABINET DEPTH

Notes:

- Standard wall cabinets are 12" deep. Refrigerator cabinets are 24" deep.
- Add door thickness for total cabinet depth.
- Please refer to the Products by Cabinet Line chart to determine which products are carried for each cabinet line.

24" High Double Door Wall

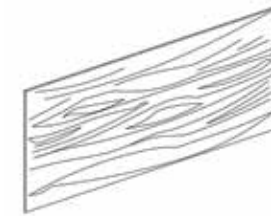

Item Code	Outer Dimensions		
	W	H	D
W3024	30	24	12
W3324	33	24	12
W3624	36	24	12

15" Wall Stacking Cabinets with Glass



Item Code	Outer Dimensions		
	W	H	D
WS2415-2	24	15	12
WS2715-2	27	15	12
WS3015-2	30	15	12
WS3315-2	33	15	12
WS3615-2	36	15	12

*Door comes pre-routed with glass insert and finished interior

24" Deep Wall (Refrigerator Cabinet)

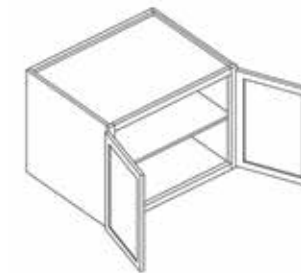

Item Code	Outer Dimensions		
	W	H	D
W331824	33	18	24
W332424	33	24	24
W361824	36	18	24
W362424	36	24	24

15" Wall Stacking Cabinets with Glass

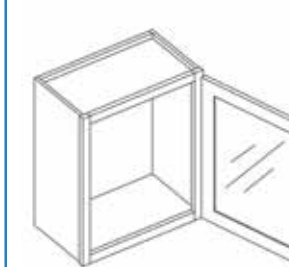

Item Code	Outer Dimensions		
	W	H	D
WS1215	12	15	12
WS1515	15	15	12
WS1815	18	15	12
WS2115	21	15	12

*Door comes pre-routed with glass insert and finished interior

30" Microwave Wall Cabinet



Item Code	Outer Dimensions		
	W	H	D
MWC3018	30	18	12

15" Corner Wall Stacking Cabinet with Glass

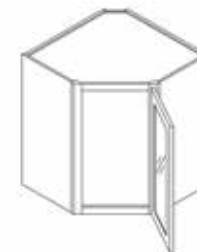

Item Code	Outer Dimensions		
	W	H	D
CWS2415	24	15	12
CWS2715	27	15	15

*Door comes pre-routed with glass insert and finished interior

30" - 36" High Single Door Wall

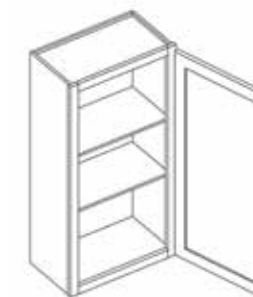

Item Code	Outer Dimensions		
	W	H	D
W930	9	30	12
W1230	12	30	12
W1530	15	30	12
W1830	18	30	12
W2130	21	30	12
W936	9	36	12
W1236	12	36	12
W1536	15	36	12
W1836	18	36	12
W2136	21	36	12

12" - 21" High Double Door Wall

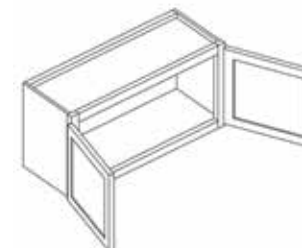

Item Code	Outer Dimensions		
	W	H	D
W3012	30	12	12
W3612	36	12	12
W3015	30	15	12
W3312	33	12	12
W3315	33	15	12
W3615	36	15	12
W3018	30	18	12
W3318	33	18	12
W3618	36	18	12
W3021	30	21	12

30" - 36" High Double Door Wall

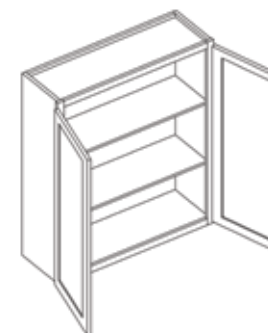

Item Code	Outer Dimensions		
	W	H	D
W2430-2	24	30	12
W2730	27	30	12
W3030	30	30	12
W3330	33	30	12
W3630	36	30	12
W3930	39	30	12
W2436-2	24	36	12
W2736	27	36	12
W3036	30	36	12
W3336	33	36	12
W3636	36	36	12
W3936	39	36	12



Installing a Blind Wall Cabinet

Proper installation ensures that the doors will open and show correct reveal

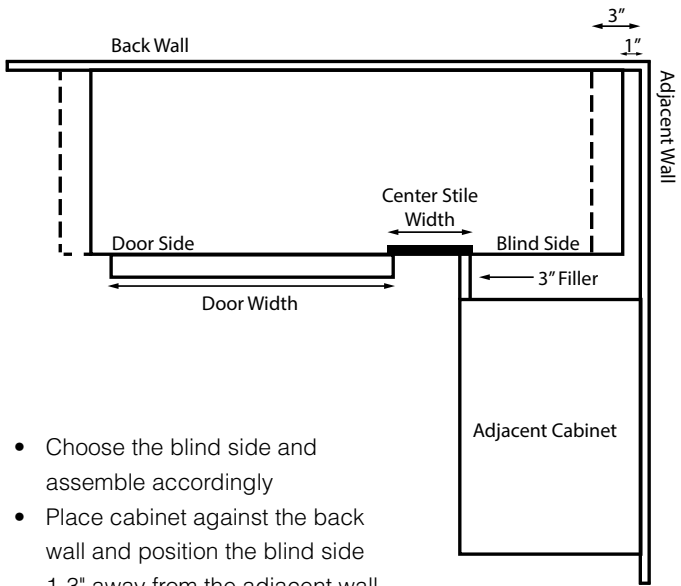

- Choose the blind side and assemble accordingly
- Place cabinet against the back wall and position the blind side 1-3" away from the adjacent wall
- Place at least a 3" filler next to the adjacent cabinet

Wall Tower with 3 Drawers

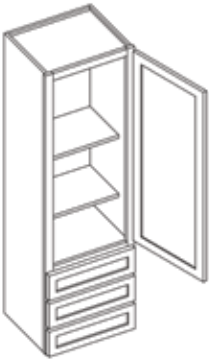

Item Code	Outer Dimensions		
	W	H	D
DWR1548	15	48	15
DWR1554	15	54	15
DWR1560	15	60	15

*Works great with a vanity

Wine Rack

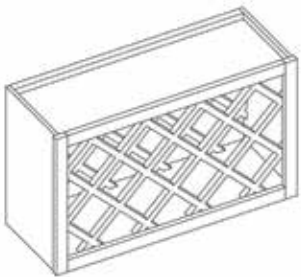

Item Code	Outer Dimensions		
	W	H	D
WR3018	30	18	12

30" - 36" High Double Door with Center Stile

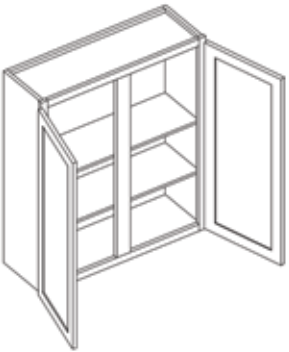

Item Code	Outer Dimensions		
	W	H	D
W4230	42	30	12
W4236	42	36	12

42" High Double Door Wall

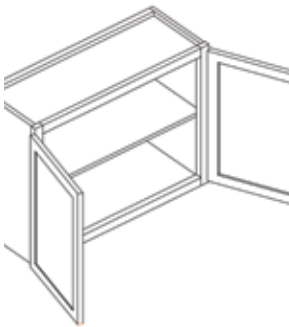

Item Code	Outer Dimensions		
	W	H	D
W2442-2	24	42	12
W2742	27	42	12
W3042	30	42	12
W3342	33	42	12
W3642	36	42	12
W3942	39	42	12

30" - 36" High Corner Wall

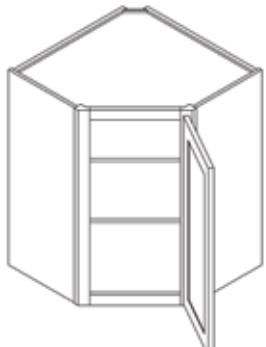

Item Code	Outer Dimensions		
	W	H	D
CW2430	24	30	12
CW2436	24	36	12
CW2736	27	36	15

42" High Single Door Wall

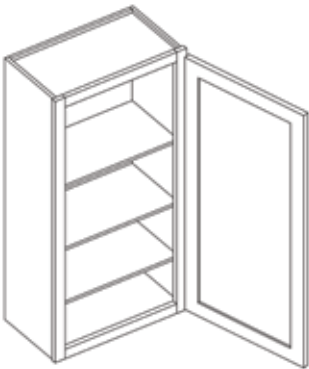

Item Code	Outer Dimensions		
	W	H	D
W942	9	42	12
W1242	12	42	12
W1542	15	42	12
W1842	18	42	12
W2142	21	42	12

42" High Double Door Wall with Center Stile

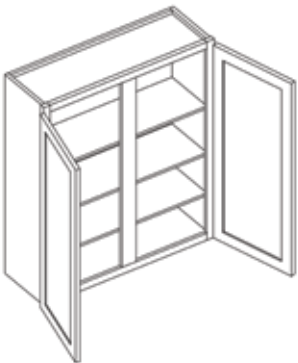

Item Code	Outer Dimensions		
	W	H	D
W4242	42	42	12

42" High Corner Wall

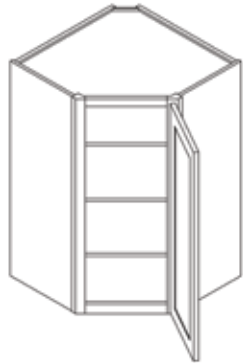

Item Code	Outer Dimensions		
	W	H	D
CW2442	24	42	12
CW2742	27	42	15

30" - 36" High Blind Wall



Item Code	Outer Dimensions		
	W	H	D
BW2430	24	30	12
BW3030	30	30	12
BW3630	36	30	12
BW2436	24	36	12
BW3036	30	36	12
BW3636	36	36	12

42" High Blind Wall



Item Code	Outer Dimensions		
	W	H	D
BW3042	30	42	12



Base Cabinet Coding

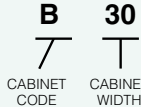

- Notes:
- Standard base cabinets are 24" deep and 34.5" high.
 - Add door thickness for total cabinet depth.
 - Please refer to the Products by Cabinet Line chart to determine which products are carried for each cabinet line.
 - NW has single drawer on B12-B36.

Double Door Standard Base with Center Stile



Item Code	Outer Dimensions		
	W	H	D
B42	42	34.5	24

Sink Base

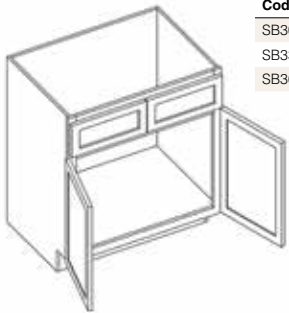

Item Code	Outer Dimensions		
	W	H	D
SB30	30	34.5	24
SB33	33	34.5	24
SB36	36	34.5	24



Microwave Base Cabinet



Item Code	Outer Dimensions		
	W	H	D
MBC30	30	34.5	24

*Finished interior

Double Door Standard Base



Item Code	Outer Dimensions		
	W	H	D
B24-2*	24	34.5	24
B27	27	34.5	24
B30	30	34.5	24
B33	33	34.5	24
B36	36	34.5	24
B39	39	34.5	24

- *B24-2 has one drawer and two doors
*Napa White has single drawer up to B36.

Desk Drawer Base



Item Code	Outer Dimensions		
	W	H	D
DDB18	18	29.5	24

Sink Base with Center Stile



Item Code	Outer Dimensions		
	W	H	D
SB42	42	34.5	24
SB48	48	34.5	24

Single Door Full Height Base

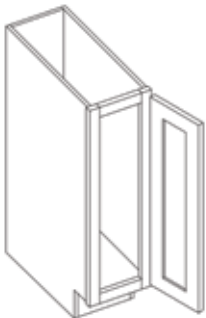

Item Code	Outer Dimensions		
	W	H	D
B09	9	34.5	24

Easy Reach

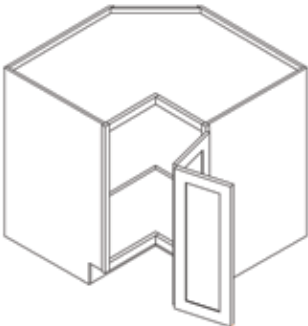

Item Code	Outer Dimensions		
	W	H	D
ER33	33	34.5	24
ER36	36	34.5	24

Cooking Center



Item Code	Outer Dimensions		
	W	H	D
CC30	30	34.5	24

36" Farm Sink Base

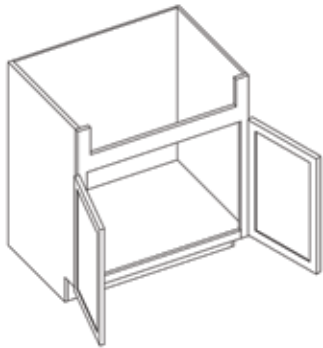

Item Code	Outer Dimensions		
	W	H	D
FSB36	36	34.5	24

*Height of sink inset is 13.5"

Single Door Standard Base



Item Code	Outer Dimensions		
	W	H	D
B12	12	34.5	24
B15	15	34.5	24
B18	18	34.5	24
B21	21	34.5	24

Trash Can Base (Full Height)

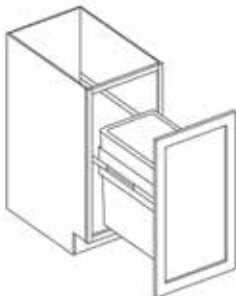

Item Code	Outer Dimensions		
	W	H	D
TRB-1*	18	34.5	24
TRB-2**	18	34.5	24

- *Includes one 50 QT can
**Includes two 35 QT cans

Drawer Base



Item Code	Outer Dimensions		
	W	H	D
DB12-3	12	34.5	24
DB15-3	15	34.5	24
DB18-3	18	34.5	24
DB21-3	21	34.5	24
DB24-3	24	34.5	24
DB27-3	24	34.5	24
DB30-3	30	34.5	24
DB33-3	33	34.5	24
DB36-3	36	34.5	24

Drawer Base - 2 Drawer



Item Code	Outer Dimensions		
	W	H	D
DB30-2	30	34.5	24
DB36-2	36	34.5	24

Corner Sink Front

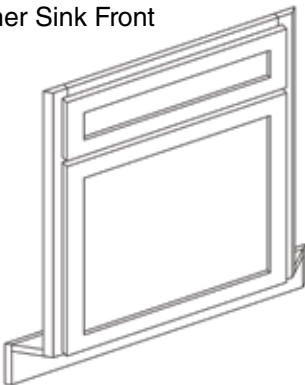

Item Code	Outer Dimensions		
	W	H	D
CSF42	27	34.5	2
CSF-FLOOR*	48	0.5	48

- *Sink floor not pictured and sold separately
* Back of face frame measures 27" wide

36" Blind Base

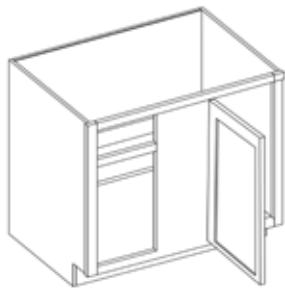

Item Code	Outer Dimensions		
	W	H	D
BB36	30	34.5	24

42" - 48" Blind Base

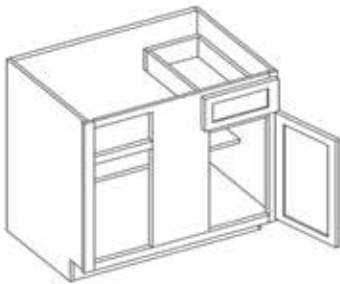

Item Code	Outer Dimensions		
	W	H	D
BB42	42	34.5	24
BB48	48	34.5	24

Installing a Blind Base Cabinet

Proper installation ensures that the drawer will clear hardware, and doors will open, and show correct reveal

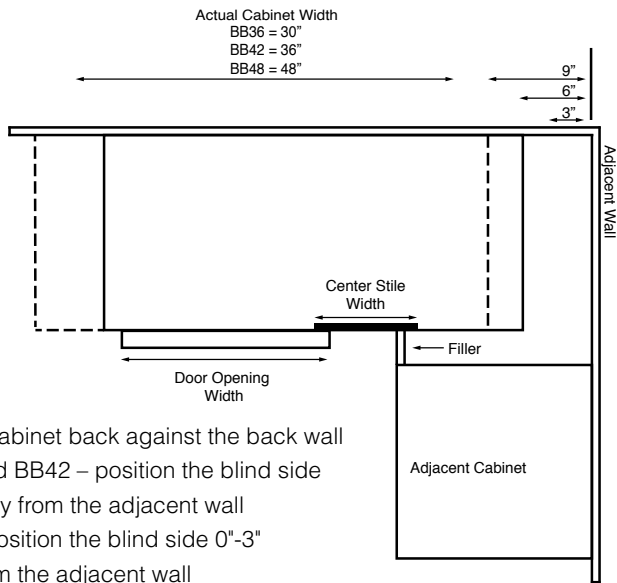

- Place the cabinet back against the back wall
 - BB36 and BB42 – position the blind side 6"-9" away from the adjacent wall
 - BB48 - position the blind side 0"-3" away from the adjacent wall
- Place at least a 3" filler next to adjacent cabinet

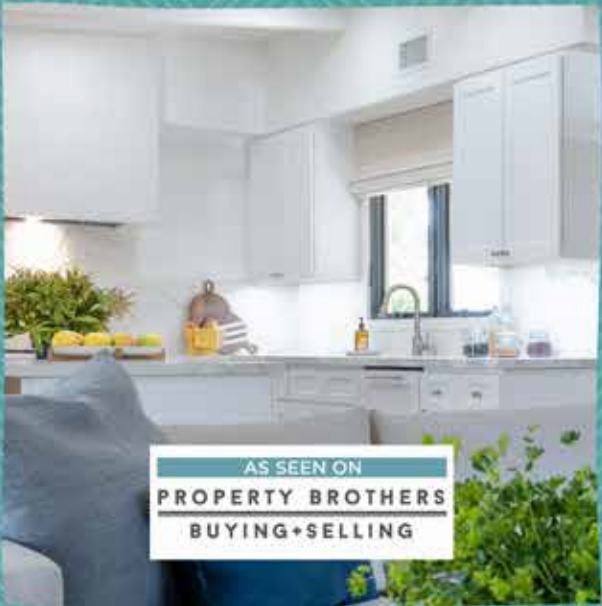

Tall Cabinet Coding

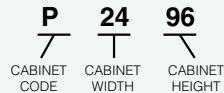

- Notes:
- Standard tall cabinets are 24" deep.
 - Add door thickness for total cabinet depth.
 - Please refer to the Products by Cabinet Line chart to determine which products are carried for each cabinet line.

Single Door Pantry

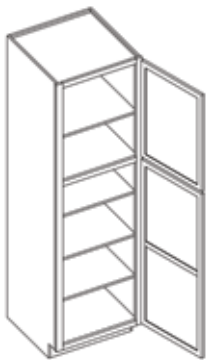

Item Code	Outer Dimensions		
	W	H	D
P1884*	18	84	24
P1890*	18	90	24
P1896**	18	96	24

*Includes four shelves
**Includes five shelves

24" and 30" Double Door Pantry

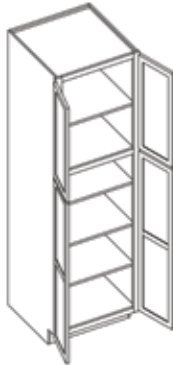

Item Code	Outer Dimensions		
	W	H	D
P2484*	24	84	24
P2490*	24	90	24
P2496**	24	96	24
P3090*	30	90	24
P3096**	30	96	24

*Includes four shelves
**Includes five shelves

Oven Cabinet (Includes One Drawer)



Item Code	Outer Dimensions		
	W	H	D
OC3390	33	90	24
OC3396	33	96	24

*Includes one drawer



Oven Cabinet Drawer



Item Code	Outer Dimensions		
	W	H	D
OCD337	32.5	6.75	24

Oven Cabinet Overlay Panel



Item Code	Outer Dimensions		
	W	H	D
OP3353	32.5	53	0.75

Vanity Cabinet Coding

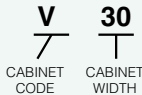

- Notes:
- Standard vanity cabinets are 21" deep.
 - Add door thickness for total cabinet depth.
 - Please refer to the Products by Cabinet Line chart to determine which products are carried for each cabinet line.
 - The V24 only comes with 1 drawer in Napa White

Vanity Combo Cabinet 36"



Item Code	Outer Dimensions		
	W	H	D
VSBD36	36	34.5	21
VSBDL36	36	34.5	21

*Pictured is the VSBDL36

Vanity Combo Cabinet 30"

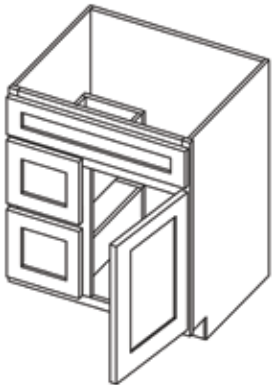

Item Code	Outer Dimensions		
	W	H	D
VSBD30	30	34.5	21
VSBDL30	30	34.5	21

*Pictured is the VSBDL30

Single Door Vanity

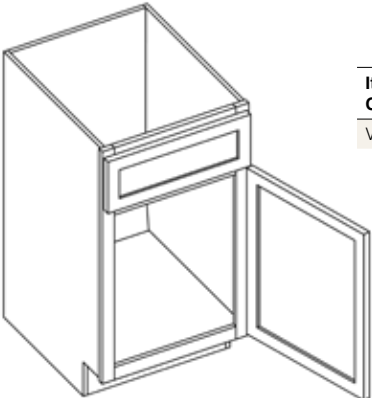

Item Code	Outer Dimensions		
	W	H	D
V21	21	34.5	21



36" Open Shelf Vanity Sink Base

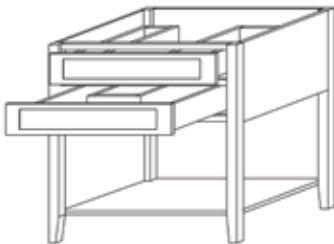

Item Code	Outer Dimensions		
	W	H	D
VSBS36	36	34.5	21

*Includes adjustable feet
*Height does not include adjustable foot

Double Door Vanity



Item Code	Outer Dimensions		
	W	H	D
V24-2	24	34.5	21
V27	27	34.5	21
V30	30	34.5	21
V33	33	34.5	21
V36	36	34.5	21

Vanity Drawer Base



Item Code	Outer Dimensions		
	W	H	D
VDB12	12	34.5	21
VDB15	15	34.5	21
VDB18	18	34.5	21
VDB21	21	34.5	21
VDB24	24	34.5	21

Vanity Sink Base



Item Code	Outer Dimensions		
	W	H	D
VSB36	36	34.5	21
VSB42	42	34.5	21
VSB48	48	34.5	21

Extended Vanity Sink Base

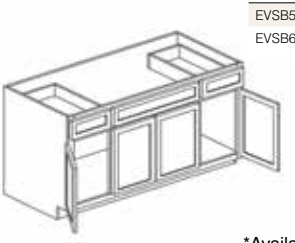

Item Code	Outer Dimensions		
	W	H	D
EVSB54	54	34.5	21
EVSB60	60	34.5	21

*Available in Taylor only

Toe Kick - TKS8

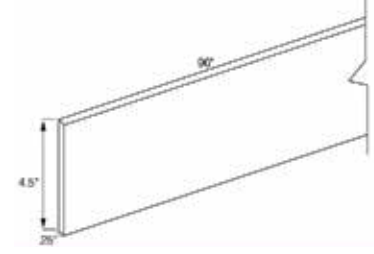

Large Crown Moulding - BCM8

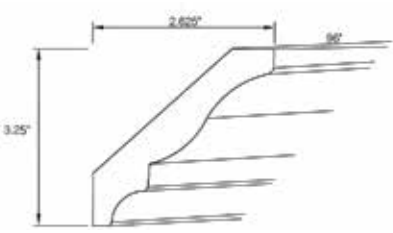

Outside Corner Moulding - OCM8

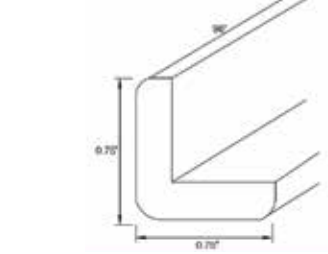

Single Door Vanity Base



Item Code	Outer Dimensions		
	W	H	D
VB12	12	34.5	21
VB15	15	34.5	21
VB18	18	34.5	21

Double Vanity Sink Base



Item Code	Outer Dimensions		
	W	H	D
DVSB54	54	34.5	21

*Available in Taylor only

24" Vanity Drawer



Item Code	Outer Dimensions		
	W	H	D
KD24	23.5	4.75	21

*Drawer box height is 2"

Scribe - SCRIBE

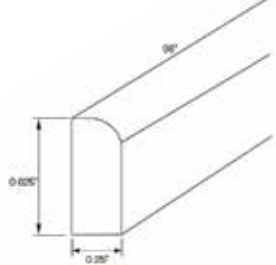

Royal Crown Moulding - RCM8

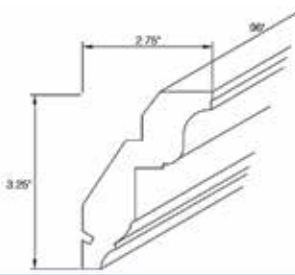

Traditional Light Rail Moulding - LRM8

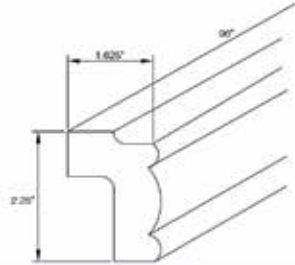

Shoe - SHOE

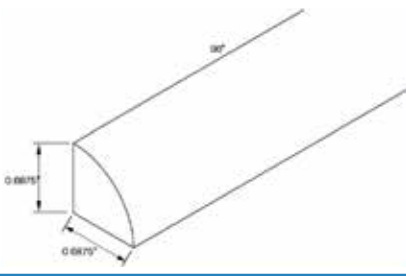

Shaker Crown Moulding - SCM8

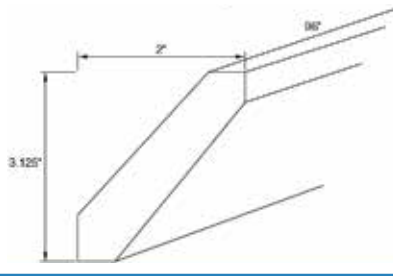

Bottom Edge Moulding - BEM8

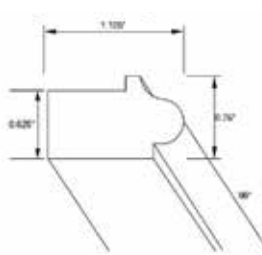

36" Vanity Drawer



Item Code	Outer Dimensions		
	W	H	D
KD36	29.5	4.75	21

*Adjustable Sides
*Drawer box height is 2"
*Trimable to 30"

Furniture Base Moulding - FBM8

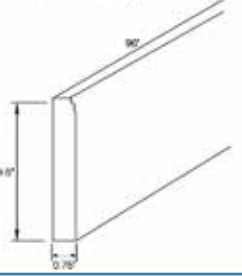

Cove Crown Moulding - COM8

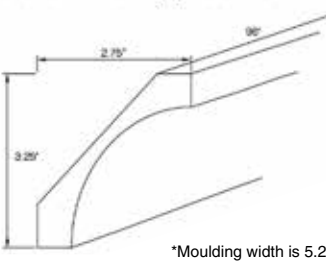

*Moulding width is 5.25"

Traditional Crown Moulding - CM8

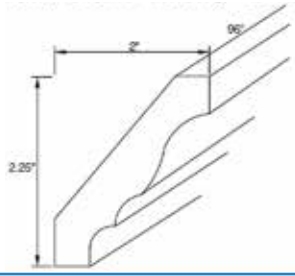

Batten Moulding - BAM8

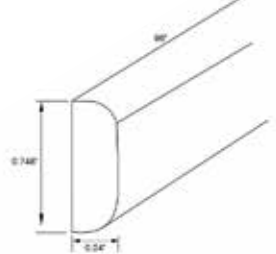

Back Panel - Long Grain Plywood



Item Code	Outer Dimensions		
	W	H	D
BPLG4896	48	96	0.25

*Finished one side, raw back

1/2" Thick Finished Plywood Panel



Item Code	Outer Dimensions		
	W	H	D
PSP4896	96	48	0.5

*Finished one side, natural UV back

Corbel - Basic Medium

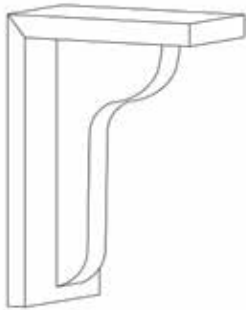

Item Code	Outer Dimensions		
	W	H	D
CORSM	3	10.5	7.5

Corbel - Transitional

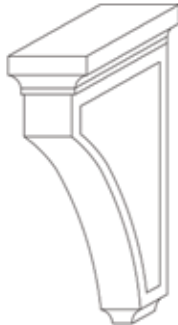

Item Code	Outer Dimensions		
	W	H	D
CORT	3.5	10.5	7

Turned Post



Item Code	Outer Dimensions		
	W	H	D
TPOSTP3	3	35.5	3
TPOSTP5	5	35.5	5

Back Panel - Short Grain Plywood

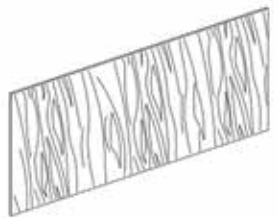

Item Code	Outer Dimensions		
	W	H	D
BPSG9648	96	48	0.25

*Finished one side, raw back

Bead Board

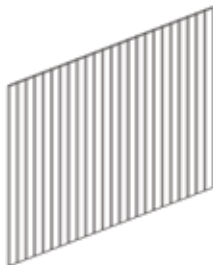

Item Code	Outer Dimensions		
	W	H	D
BBP4842	48	42	0.25

*Finished one side, raw back

Bunfoot - Transitional

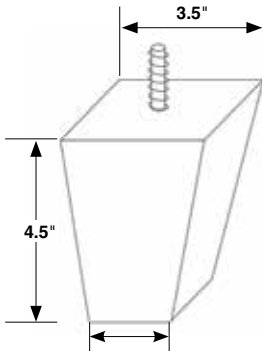

Item Code	Outer Dimensions		
	H	Top	Bottom
TBUNFOOT2	4.5	3.5	2

Raised Panel Valance

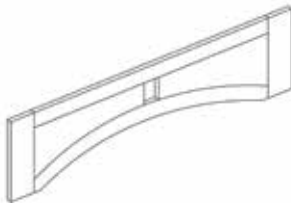

Item Code	Outer Dimensions		
	W	H	D
VRP42	42	12	0.75
VRP48	48	12	0.75

Decorative Base/Wall Panels

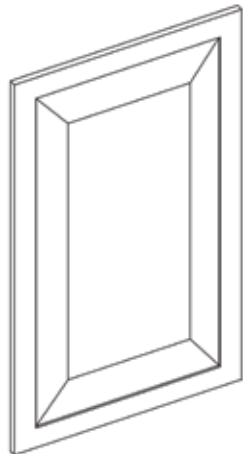

Item Code	Outer Dimensions		
	W	H	D
DWP1215	11.5	13.75	0.75
DWP2415	23.5	13.75	0.75
DWP1230	11.5	28.75	0.75
DWP2430	23.5	28.75	0.75
DWP1236	11.5	34.75	0.75
DWP1242	11.5	40.75	0.75

Filler



Item Code	Outer Dimensions		
	W	H	D
F396	3	96	0.75
F696	6	96	0.75

*All four edges finished

Overlay Filler



Item Code	Outer Dimensions		
	W	H	D
OLF330	2.5	28.75	0.75
OLF336	2.5	34.75	0.75
OLF342	2.5	40.75	0.75
OLF630**	5.5	28.75	0.75

*All four edges finished
**Available only in Premier

Fluted Filler



Item Code	Outer Dimensions		
	W	H	D
FF396	3	96	0.75

*All four edges finished

Dishwasher End Panel



Item Code	Outer Dimensions		
	W	H	D
DWR3	3	34.5	24

*0.5" panel thickness
*Finished one side, natural UV back
*Value series finished on both sides

Furniture Valance



Item Code	Outer Dimensions		
	W	H	D
VFUNR37	37	4.5	0.75

Bunfoot



Item Code	Outer Dimensions		
	W	H	D
TBUNFOOT	3	4.5	3



Tall End Panel



Item Code	Outer Dimensions		
	W	H	D
TEP3096	1.5	96	30

*0.5" panel thickness
*Finished one side, natural UV back
*Value Series finished on both sides

Bookcase End



Item Code	Outer Dimensions		
	W	H	D
BCE1596	1.5	96	15

*Requires shelf
*Shelf clips available
*0.5" panel thickness

Shelf



Item Code	Outer Dimensions		
	W	H	D
**SHELF1296	96	0.625	12
***SHELF2496	96	0.625	24

*All sides finished
*3/4" plywood construction
**Available in natural or painted
***Available in natural only

Soft Close Roll Out Tray

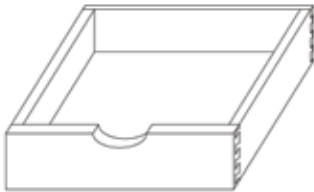

*Includes two trays & four tracks

Item Code	Outer Dimensions		
	W	H	D
ROT15-SC	10.125	4	21
ROT18-SC	13.125	4	21
ROT21-SC	16.125	4	21
ROT24-SC	19.125	4	21
ROT27-SC	22.125	4	21
ROT30-SC	25.125	4	21
ROT33-SC	28.125	4	21
ROT36-SC	31.125	4	21

Lazy Susan Kit



*Includes two trays for shelf mounting
*Birch plywood construction

Item Code	Outer Dimensions		
	W	H	D
LSK	29	1.5	29

Trash Can Insert for B18



Dovetail, solid wood construction
Undermount, full extension, soft close slides

*Includes two 35 QT cans

Item Code	Outer Dimensions		
	W	H	D
TCCK*	14.625	4.125	19.75

Spice Rack Insert



*Fits in the B09

Item Code	Outer Dimensions		
	W	H	D
SRI9	5.75	24	20.5

Cutlery Drawer Insert

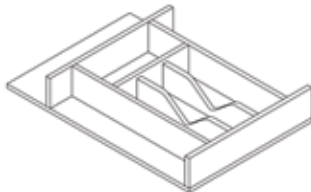

Item Code	Outer Dimensions		
	W	H	D
CDI14	13.375	1.75	19.75
CDI20	19.75	1.75	19.75

Roll Out Tray Usage Guide

Item Code	Designed to Fit
ROT15-SC	B15
ROT18-SC	B18, P1884, P1890, P1896
ROT21-SC	B21
ROT24-SC	B24, P2484, P2490, P2496
ROT27-SC	B27
ROT30-SC	B30, SB30, P3084, P3090, P3096
ROT33-SC	B33, SB33
ROT36-SC	B36, SB36

Spice Rack Door Attachment

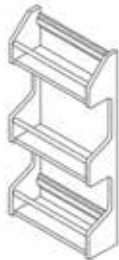

Item Code	Outer Dimensions		
	W	H	D
SRD12	11.5	24	4
SRD15	14.5	24	4

Spice Tray Insert



Item Code	Outer Dimensions		
	W	H	D
STI14	13.375	1.094	19.75
STI20	19.75	1.094	19.75

Stemware Rack

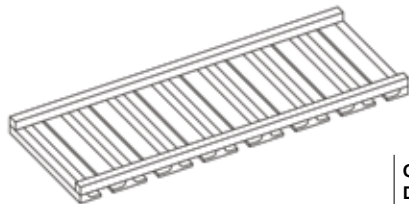

Item Code	Outer Dimensions		
	W	H	D
SWR3012	28.5	1.5	10.5



kcdus.com/hardware

Discover The Perfect Pairing:

Over 100+ Options



Introducing KCD's Decorative Hardware Collection, designed to provide the perfect complement to our cabinet door styles. The expansive assortment of possibilities will make it easy to find the perfect pair.

Colorado Pull



Shown In Matte Black

Square Knob



Shown In Rose Gold

Bar Pull Knob



Shown In Rubbed Oil Bronze

Bar Pull



Shown In Satin Nickel

Manhattan Pull



Shown In Rose Gold

Colorado Knob



Shown In Polished Chrome

Miami Pull



Shown In Dark Pewter

Round Flat Top Knob



Shown In Dark Pewter

Diecast Knob



Shown In Dark Pewter

Modern Square Pull



Shown In Matte Black

Available Finishes:



Rose Gold



Satin Nickel



Matte Black



Polished Chrome



Stainless Steel



Brushed Bronze

*Accessories displayed on this page can be installed on assembled orders

Item Code	Item Description	Shaker Sand	Shaker Designer White	Shaker Espresso	Brooklyn Modern Gray	Brooklyn Bright White	Brooklyn Slate	Lenox Country Linen	Lenox Canvas	Napa White	Taylor White	Taylor Espresso
		Premier									Value	
Wall Cabinets												
W3012	Double Door Wall Cabinet - 30" W x 12" H	●	●	●	●	●	●	●	●	●	●	●
W3312	Double Door Wall Cabinet - 33" W x 12" H	●	●	●	●	●	●	●	●	●	-	-
W3612	Double Door Wall Cabinet - 36" W x 12" H	●	●	●	●	●	●	●	●	●	●	●
W3015	Double Door Wall Cabinet - 30" W x 15" H	●	●	●	●	●	●	●	●	●	●	●
W3615	Double Door Wall Cabinet - 36" W x 15" H	●	●	●	●	●	●	●	●	●	●	●
WS1215	15" Wall Stacking Cabinets with Glass	●	●	●	●	●	●	-	-	●	-	-
WS1515	15" Wall Stacking Cabinets with Glass	●	●	●	●	●	●	-	-	●	-	-
WS1815	15" Wall Stacking Cabinets with Glass	●	●	●	●	●	●	-	-	●	-	-
WS2115	15" Wall Stacking Cabinets with Glass	●	●	●	●	●	●	-	-	●	-	-
WS2415-2	15" Wall Stacking Cabinets with Glass	●	●	●	●	●	●	-	-	●	-	-
WS2715-2	15" Wall Stacking Cabinets with Glass	●	●	●	●	●	●	-	-	●	-	-
WS3015-2	15" Wall Stacking Cabinets with Glass	●	●	●	●	●	●	-	-	●	-	-
WS3315-2	15" Wall Stacking Cabinets with Glass	●	●	●	●	●	●	-	-	●	-	-
WS3615-2	15" Wall Stacking Cabinets with Glass	●	●	●	●	●	●	-	-	●	-	-
W3018	Double Door Wall Cabinet - 30" W x 18" H	●	●	●	●	●	●	●	●	●	●	●
W3312	Double Door Wall Cabinet - 33" W x 12" H	●	●	●	●	●	●	-	-	-	-	-
W3318	Double Door Wall Cabinet - 33" W x 18" H	●	●	●	●	●	●	●	●	●	-	-
W3618	Double Door Wall Cabinet - 36" W x 18" H	●	●	●	●	●	●	●	●	●	●	●
W3021	Double Door Wall Cabinet - 30" W x 21" H	●	●	●	●	●	●	●	●	●	-	-
W3024	Double Door Wall Cabinet - 30" W x 24" H	●	●	●	●	●	●	●	●	●	●	●
W3324	Double Door Wall Cabinet - 33" W x 24" H	●	●	●	●	●	●	●	●	●	-	-
W3624	Double Door Wall Cabinet - 36" W x 24" H	●	●	●	●	●	●	●	●	●	●	●
W331824	Deep Wall Cabinet - 33" W x 18" H x 24" D	●	●	●	●	●	●	-	-	●	-	-
W361824	Deep Wall Cabinet - 36" W x 18" H x 24" D	●	●	●	●	●	●	●	●	●	●	●
W332424	Deep Wall Cabinet - 33" W x 24" H x 24" D	●	●	●	●	●	●	-	-	●	-	-
W362424	Deep Wall Cabinet - 36" W x 24" H x 24" D	●	●	●	●	●	●	●	●	●	●	●
W930	Single Door Wall Cabinet - 9" W x 30" H	●	●	●	●	●	●	●	●	●	●	●
W1230	Single Door Wall Cabinet - 12" W x 30" H	●	●	●	●	●	●	●	●	●	●	●
W1530	Single Door Wall Cabinet - 15" W x 30" H	●	●	●	●	●	●	●	●	●	●	●
W1830	Single Door Wall Cabinet - 18" W x 30" H	●	●	●	●	●	●	●	●	●	●	●
W2130	Single Door Wall Cabinet - 21" W x 30" H	●	●	●	●	●	●	●	●	●	●	●
W936	Single Door Wall Cabinet - 9" W x 36" H	●	●	●	●	●	●	●	●	●	●	●
W1236	Single Door Wall Cabinet - 12" W x 36" H	●	●	●	●	●	●	●	●	●	●	●
W1536	Single Door Wall Cabinet - 15" W x 36" H	●	●	●	●	●	●	●	●	●	●	●
W1836	Single Door Wall Cabinet - 18" W x 36" H	●	●	●	●	●	●	●	●	●	●	●
W2136	Single Door Wall Cabinet - 21" W x 36" H	●	●	●	●	●	●	●	●	●	●	●
W2430-2	Double Door Wall Cabinet - 24" W x 30" H	●	●	●	●	●	●	●	●	●	●	●
W2730	Double Door Wall Cabinet - 27" W x 30" H	●	●	●	●	●	●	●	●	●	●	●
W3030	Double Door Wall Cabinet - 30" W x 30" H	●	●	●	●	●	●	●	●	●	●	●
W3330	Double Door Wall Cabinet - 33" W x 30" H	●	●	●	●	●	●	●	●	●	●	●
W3630	Double Door Wall Cabinet - 36" W x 30" H	●	●	●	●	●	●	●	●	●	●	●
W3930	Double Door Wall Cabinet - 39" W x 30" H	●	●	●	●	●	●	●	●	●	-	-
W2436-2	Double Door Wall Cabinet - 24" W x 36" H	●	●	●	●	●	●	●	●	●	●	●
W2736	Double Door Wall Cabinet - 27" W x 36" H	●	●	●	●	●	●	●	●	●	●	●
W3036	Double Door Wall Cabinet - 30" W x 36" H	●	●	●	●	●	●	●	●	●	●	●
W3336	Double Door Wall Cabinet - 33" W x 36" H	●	●	●	●	●	●	●	●	●	●	●
W3636	Double Door Wall Cabinet - 36" W x 36" H	●	●	●	●	●	●	●	●	●	●	●
W3936	Double Door Wall Cabinet - 39" W x 36" H	●	●	●	●	●	●	●	●	●	-	-
W4230	Double Door Wall Cabinet - 42" W x 30" H	●	●	●	●	●	●	●	●	●	-	-
W4236	Double Door Wall Cabinet - 42" W x 36" H	●	●	●	●	●	●	●	●	●	-	-

Item Code	Item Description	Shaker Sand	Shaker Designer White	Shaker Espresso	Brooklyn Modern Gray	Brooklyn Bright White	Brooklyn Slate	Lenox Country Linen	Lenox Canvas	Napa White	Taylor White	Taylor Espresso
		Premier									Value	
Wall Cabinets												
BW2430	Blind Wall Cabinet - 24" W x 30" H	●	●	●	●	●	●	●	●	●	-	-
BW3030	Blind Wall Cabinet - 30" W x 30" H	●	●	●	●	●	●	●	●	●	●	●
BW3630	Blind Wall Cabinet - 36" W x 30" H	●	●	●	●	●	●	●	●	●	●	●
BW2436	Blind Wall Cabinet - 24" W x 36" H	●	●	●	●	●	●	●	●	●	-	-
BW3036	Blind Wall Cabinet - 30" W x 36" H	●	●	●	●	●	●	●	●	●	●	●
BW3636	Blind Wall Cabinet - 36" W x 36" H	●	●	●	●	●	●	●	●	●	●	●
CW2430	Corner Wall Cabinet - 24" W x 30" H	●	●	●	●	●	●	●	●	●	●	●
CW2436	Corner Wall Cabinet - 24" W x 36" H	●	●	●	●	●	●	●	●	●	●	●
CW2736	Corner Wall Cabinet - 27" W x 36" H	●	●	●	●	●	●	●	●	●	●	●
CWS2415	15" Corner Wall Stacking Cabinets	●	●	●	●	●	●	-	-	●	-	-
CWS2735	15" Corner Wall Stacking Cabinets	●	●	●	●	●	●	-	-	●	-	-
W942	Single Door Wall Cabinet - 9" W x 42" H	●	●	●	●	●	●	●	●	●	●	●
W1242	Single Door Wall Cabinet - 12" W x 42" H	●	●	●	●	●	●	●	●	●	●	●
W1542	Single Door Wall Cabinet - 15" W x 42" H	●	●	●	●	●	●	●	●	●	●	●
W1842	Single Door Wall Cabinet - 18" W x 42" H	●	●	●	●	●	●	●	●	●	●	●
W2142	Single Door Wall Cabinet - 21" W x 42" H	●	●	●	●	●	●	●	●	●	●	●
W2442-2	Double Door Wall Cabinet - 24" W x 42" H	●	●	●	●	●	●	●	●	●	●	●
W2742	Double Door Wall Cabinet - 27" W x 42" H	●	●	●	●	●	●	●	●	●	●	●
W3042	Double Door Wall Cabinet - 30" W x 42" H	●	●	●	●	●	●	●	●	●	●	●
W3342	Double Door Wall Cabinet - 33" W x 42" H	●	●	●	●	●	●	●	●	●	●	●
W3642	Double Door Wall Cabinet - 36" W x 42" H	●	●	●	●	●	●	●	●	●	●	●
W3942	Double Door Wall Cabinet - 39" W x 42" H	●	●	●	●	●	●	●	●	●	-	-
W4242	Double Door Wall Cabinet - 42" W x 42" H	●	●	●	●	●	●	●	●	●	-	-
BW3042	Blind Wall Cabinet - 30" W x 42" H	●	●	●	●	●	●	●	●	●	●	●
BW3642	Blind Wall Cabinet - 36" W x 42" H	●	●	●	●	●	●	●	●	●	●	●
CW2442	Corner Wall Cabinet - 24" W x 42" H	●	●	●	●	●	●	●	●	●	●	●
CW2742	Corner Wall Cabinet - 27" W x 42" H	●	●	●	●	●	●	●	●	●	●	●
DWR1548	Wall Twr w/ 3 Drws - 15" W x 48" H x 15" D	●	●+	●	●	●	●	●	●	●	-	-
DWR1554	Wall Twr w/ 3 Drws - 15" W x 54" H x 15" D	●	●+	●	●	●	●	●	●	●	-	-
DWR1560	Wall Twr w/ 3 Drws - 15" W x 60" H x 15" D	●	●+	●	●	●	●	●	●	●	-	-
MWC3018	Microwave Wall Cabinet - 30" W x 18" H x 12" D	●	●	●	●	●	●	●	●	●	-	-
WR3018	Wine Rack - 30" W x 18" H x 12" D	●	●	●	●	●	●	●	●	●	●	●
Base Cabinets												
B09	Single Door Full Height Base Cabinet - 9" W	●	●	●	●	●	●	●	●	●	●	●
B12	Single Door Standard Base Cabinet - 12" W	●	●+	●	●	●	●	●	●	●	●*	●*
B15	Single Door Standard Base Cabinet - 15" W	●	●+	●	●	●	●	●	●	●	●*	●*
B18	Single Door Standard Base Cabinet - 18" W	●	●+	●	●	●	●	●	●	●	●*	●*
B21	Single Door Standard Base Cabinet - 21" W	●	●+	●	●	●	●	●	●	●	●*	●*
B24-2	Double Door Standard Base Cabinet - 24" W	●	●+	●	●	●	●	●	●	●	●*	●*
B27	Double Door Standard Base Cabinet - 27" W	●	●+	●	●	●	●	●	●	●	●*	●*
B30	Double Door Standard Base Cabinet - 30" W	●	●+	●	●	●	●	●	●	●	●*	●*
B33	Double Door Standard Base Cabinet - 33" W	●	●+	●	●	●	●	●	●	●	●*	●*
B36	Double Door Standard Base Cabinet - 36" W	●	●+	●	●	●	●	●	●	●	●*	●*
B39	Double Door Standard Base Cabinet - 39" W	●	●+	●	●	●	●	●	●	●	-	-
B42	Double Door Standard Base Cabinet - 42" W	●	●+	●	●	●	●	●	●	●	-	-

*All Value Series drawers can be upgraded. Upgrade includes: Drawer Box: 5/8" Solid Wood, Dovetailed; Drawer Slides: Under Mount, Full Extension, Metal, Soft Close with Ball Bearings. All Drawer Upgrade SKUs are notated with 'DU' on the Order Form

*All Shaker Designer White drawers are available with either a slab drawer front or 5-Piece drawer front. All 5-Piece SKUs are notated with '5PC' on the Order Form

Item Code	Item Description	Shaker Sand	Shaker Designer White	Shaker Espresso	Brooklyn Modern Gray	Brooklyn Bright White	Brooklyn Slate	Lenox Country Linen	Lenox Canvas	Napa White	Taylor White	Taylor Espresso
		Premier									Value	
Base Cabinets												
DB12-3	Drawer Base Cabinet - 12" W	●	●+	●	●	●	●	●	●	●	●*	●*
DB15-3	Drawer Base Cabinet - 15" W	●	●+	●	●	●	●	●	●	●	●*	●*
DB18-3	Drawer Base Cabinet - 18" W	●	●+	●	●	●	●	●	●	●	●*	●*
DB21-3	Drawer Base Cabinet - 21" W	●	●+	●	●	●	●	●	●	●	●*	●*
DB24-3	Drawer Base Cabinet - 24" W	●	●+	●	●	●	●	●	●	●	●*	●*
DB27-3	Drawer Base Cabinet - 27" W	●	●+	●	●	●	●	-	-	-	-	-
DB30-3	Drawer Base Cabinet - 30" W	●	●+	●	●	●	●	●	●	●	●*	●*
DB33-3	Drawer Base Cabinet - 33" W	●	●+	●	●	●	●	-	-	-	-	-
DB36-3	Drawer Base Cabinet - 36" W	●	●+	●	●	●	●	●	●	●	-	-
DB30-2	2 Drawer Base Cabinet - 30" W	●	●+	●	●	●	●	●	●	●	-	-
DB36-2	2 Drawer Base Cabinet - 36" W	●	●+	●	●	●	●	●	●	●	-	-
CC30	Cooking Center Base Cabinet - 30" W	●	●+	●	●	●	●	●	●	●	●	●
FSB36	Farm Sink Base Cabinet - 36" W	●	●+	●	●	●	●	●	●	●	-	-
TRB-1	Trash Can Base w/ Full Ht Door -18" W	●	●+	●	●	●	●	●	●	●	-	-
TRB-2	Trash Can Base w/ Full Ht Door -18" W	●	●+	●	●	●	●	●	●	●	-	-
SB30	Sink Base Cabinet - 30" W	●	●+	●	●	●	●	●	●	●	●	●
SB33	Sink Base Cabinet - 33" W	●	●+	●	●	●	●	●	●	●	●	●
SB36	Sink Base Cabinet - 36" W	●	●+	●	●	●	●	●	●	●	●	●
SB42	Sink Base Cabinet w/ CS - 42" W	●	●+	●	●	●	●	●	●	●	●	●
SB48	Sink Base Cabinet w/ CS - 48" W	●	●+	●	●	●	●	●	●	●	-	-
CSF42	Corner Sink Front for 42" Space - 27" W	●	●+	●	●	●	●	●	●	●	●	●
CSF-FLOOR	Natural Corner Sink Front Floor 48" x 48"	●	●	●	●	●	●	●	●	●	●	●
BB42	Blind Base Cabinet for 42" to 45" Space - 36" W	●	●+	●	●	●	●	●	●	●	●*	●*
BB48	Blind Base Cab for 48" to 51" Space - 48" W	●	●+	●	●	●	●	●	●	●	●*	●*
ER33	Easy Reach Base Cabinet - 33" W x 33" D	●	●	●	●	●	●	●	●	●	-	-
ER36	Easy Reach Base Cabinet - 36" W x 36" D	●	●	●	●	●	●	●	●	●	●	●
DDB18	Desk Drawer Base - 18" W x 29.5" H x 24" D	●	●+	●	●	●	●	●	●	●	-	-
MBC30	Microwave Base Cabinet - 30" W	●	●+	●	●	●	●	●	●	●	-	-
Tall Cabinets												
P1884	Pantry - 18" W x 84" H	●	●	●	●	●	●	●	●	●	●	●
P1890	Pantry - 18" W x 90" H	●	●	●	●	●	●	●	●	●	●	●
P1896	Pantry - 18" W x 96" H	●	●	●	●	●	●	●	●	●	●	●
P2484	Pantry - 24" W x 84" H	●	●	●	●	●	●	●	●	●	-	-
P2490	Pantry - 24" W x 90" H	●	●	●	●	●	●	●	●	●	-	-
P2496	Pantry - 24" W x 96" H	●	●	●	●	●	●	●	●	●	-	-
P3090	Pantry - 30" W x 90" H	●	●	●	●	●	●	●	●	●	-	-
P3096	Pantry - 30" W x 96" H	●	●	●	●	●	●	●	●	●	-	-
OC3390	Oven Cabinet - 33" W x 90" H	●	●+	●	●	●	●	●	●	●	●*	●*
OC3396	Oven Cabinet - 33" W x 96" H	●	●+	●	●	●	●	●	●	●	●*	●*
OP3353	Oven Cabinet Overlay Panel - 33" W x 53" H	●	●	●	●	●	●	●	●	●	-	-
OCD337	Oven Cabinet Drawer	●	●+	●	●	●	●	●	●	●	●*	●*
Vanities												
V21	Single Door Vanity - 21" W	●	●+	●	●	●	●	-	-	-	-	-
V24-2	Double Door Vanity - 24" W	●	●+	●	●	●	●	●	●	●	●	●
V27	Double Door Vanity - 27" W	●	●+	●	●	●	●	●	●	●	●	●
V30	Double Door Vanity - 30" W	●	●+	●	●	●	●	●	●	●	●	●
V33	Double Door Vanity - 33" W	●	●+	●	●	●	●	●	●	●	●	●
V36	Double Door Vanity - 36" W	●	●+	●	●	●	●	●	●	●	●	●
VB12	Single Door Base Vanity - 12" W	●	●+	●	●	●	●	●	●	●	-	-
VB15	Single Door Base Vanity - 15" W	●	●+	●	●	●	●	●	●	●	●*	●*
VB18	Single Door Base Vanity - 18" W	●	●+	●	●	●	●	●	●	●	●*	●*

Item Code	Item Description	Shaker Sand	Shaker Designer White	Shaker Espresso	Brooklyn Modern Gray	Brooklyn Bright White	Brooklyn Slate	Lenox Country Linen	Lenox Canvas	Napa White	Taylor White	Taylor Espresso
		Premier									Value	
Vanities												
VDB12	Vanity Drawer Base - 12" W	●+	●+	●	●	●	●	●	●	●	●*	●*
VDB15	Vanity Drawer Base - 15" W	●+	●+	●	●	●	●	●	●	●	●*	●*
VDB18	Vanity Drawer Base - 18" W	●+	●+	●	●	●	●	●	●	●	●*	●*
VDB21	Vanity Drawer Base - 21" W	-	-	-	-	-	-	-	-	-	●*	●*
VDB24	Vanity Drawer Base - 24" W	●+	●+	●	●	●	●	●	●	●	●*	●*
VSΒ36	Vanity Sink Base - 36" W	●+	●+	●	●	●	●	●	●	●	●*	●*
VSΒ42	Vanity Sink Base - 42" W	●+	●+	●	●	●	●	●	●	●	●*	●*
VSΒ48	Vanity Sink Base - 48" W	●+	●+	●	●	●	●	●	●	●	●*	●*
VSΒDR30	Vanity Sink Drawer Base Right - 30" W	●+	●+	●	●	●	●	-	-	●	-	-
VSΒDL30	Vanity Sink Drawer Base Left - 30" W	●+	●+	●	●	●	●	-	-	●	-	-
VSΒDR36	Vanity Sink Drawer Base Right – 36" W	●+	●+	●	●	●	●	●	●	●	-	-
VSΒDL36	Vanity Sink Drawer Base Left – 36" W	●+	●+	●	●	●	●	●	●	●	-	-
DVSΒ54	Double Vanity SB - 54"W	-	-	-	-	-	-	-	-	-	●*	●*
EVSΒ54	Extended Vanity SB - 54" W	-	-	-	-	-	-	-	-	-	●*	●*
EVSΒ60	Extended Vanity SB - 60" W	-	-	-	-	-	-	-	-	-	●*	●*
KD24	Vanity Drawer - 24" W	●	●	●	●	●	●	●	●	●	-	-
KD36	Vanity Drawer - 36" W with Adjustable Sides	●	●	●	●	●	●	●	●	●	●*	●*
VSΒOS36	Open Shelf Vanity SB - 36W	●	●	●	●	●	●	-	-	●	-	-
Mouldings and Trim												
TKS8	Toe Kick	●	●	●	●	●	●	●	●	●	●	●
SCRIBE	Scribe	●	●	●	●	●	●	●	●	●	●	●
SHOE	Shoe Moulding	●	●	●	●	●	●	●	●	●	●	●
FBM8	Furniture Base Moulding	●	●	●	●	●	●	●	●	●	●	●
CM8	Traditional Crown Moulding	-	-	-	●	●	●	●	●	●	●	●
BCM8	Large Crown Moulding	-	-	-	●	●	●	●	●	●	●	●
RCM8	Royal Crown Moulding	●	●	●	●	●	●	●	●	●	-	-
SCM8	Shaker Crown Moulding	●	●	●	-	-	-	-	-	-	-	-
COM8	Cove Crown Moulding	●	●	●	●	●	●	●	●	●	●	●
BAM8	Batten Moulding	●	●	●	●	●	●	●	●	●	●	●
OCM8	Outside Corner Moulding	●	●	●	●	●	●	●	●	●	●	●
LRM8	Traditional Light Rail	●	●	●	●	●	●	●	●	●	●	●
BEM8	Bottom Edge Moulding (Narrow Light Rail)	●	●	●	●	●	●	●	●	●	-	-
Fillers and Panels												
BPLG4896	Back Panel (Long Grain) - 48" W x 96" H	●	●	●	●	●	●	●	●	●	●	●
BPSG9648	Back Panel (Short Grain) - 96" W x 48" H	-	-	●	-	-	●	-	-	-	-	●
BBP4842	Bead Board - 48" W x 42" H x 0.25" D	●	●	●	●	●	●	●	●	●	●	●
PSP4896	1/2" Thick Finished Plywood Filler	●	●	●	●	●	●	●	●	●	-	-
DWR3	Dishwasher End Panel	●	●	●	●	●	●	●	●	●	●	●
TEP3096	Tall End Panel	●	●	●	●	●	●	●	●	●	●	●
BCE1596	Book Case End - 1.5" W x 96" H x 15" D	●	●	●	●	●	●	●	●	●	-	-
F396	Filler - 3" W x 96" H	●	●	●	●	●	●	●	●	●	●	●
F696	Filler - 6" W x 96" H	●	●	●	●	●	●	●	●	●	●	●
OLF330	Overlay Filler - 3" W x 30" H	●	●	●	●	●	●	●	●	●	-	-
OLF336	Overlay Filler - 3" W x 36" H	●	●	●	●	●	●	●	●	●	-	-
OLF342	Overlay Filler - 3" W x 42" H	●	●	●	●	●	●	●	●	●	-	-
OLF630	Overlay Filler - 6" W x 30" H	●	●	●	●	●	●	●	●	●	-	-
FF396	Fluted Filler - 3" W x 96" H	-	-	-	●	●	●	●	●	●	-	-

*All Value Series drawers can be upgraded. Upgrade includes: Drawer Box: 5/8" Solid Wood, Dovetailed; Drawer Slides: Under Mount, Full Extension, Metal, Soft Close with Ball Bearings. All Drawer Upgrade SKUs are notated with 'DU' on the Order Form

*All Shaker Designer White drawers are available with either a slab drawer front or 5-Piece drawer front. All 5-Piece SKUs are notated with '5PC' on the Order Form

Item Code	Item Description	Shaker Sand	Shaker Designer White	Shaker Espresso	Brooklyn Modern Gray	Brooklyn Bright White	Brooklyn Slate	Lenox Country Linen	Lenox Canvas	Napa White	Taylor White	Taylor Espresso
		Premier									Value	
Decorative Accessories												
CORMS	Basic Medium Corbel - 10.5" H	●	●	●	●	●	●	●	●	●	●	●
CORT	Transitional Corbel	●	●	●	●	●	●	●	●	●	-	-
TBUNFOOT	Traditional Bunfoot	●	●	●	●	●	●	●	●	●	-	-
TBUNFOOT2	Transitional Bunfoot	●	●	●	●	●	●	-	-	●	-	-
TPOSTP3	Turned Post - 3" W x 35.5" H	●	●	●	●	●	●	●	●	●	-	-
TPOSTP5	Turned Post - 5" W x 35.5" H	●	●	●	●	●	●	●	●	●	-	-
VFURN37	Furniture Valance - 37" W	●	●	●	●	●	●	●	●	●	-	-
VRP42	Raised Panel Valance - 42" W	-	-	-	●	●	●	●	●	●	-	-
VRP48	Raised Panel Valance - 48" W	-	-	-	●	●	●	●	●	●	-	-
DWP1215	Decorative Wall Panel - 12" W x 15" H	●	●	●	●	●	●	-	-	●	-	-
DWP1230	Decorative Wall Panel - 12" W x 30" H	●	●	●	●	●	●	●	●	●	-	-
DWP1236	Decorative Wall Panel - 12" W x 36" H	●	●	●	●	●	●	●	●	●	-	-
DWP1242	Decorative Wall Panel - 12" W x 42" H	●	●	●	●	●	●	●	●	●	-	-
DWP2415	Decorative Wall Panel - 24" W x 15" H	●	●	●	●	●	●	-	-	●	-	-
DWP2430	Decorative Wall Panel - 24" W x 30" H	●	●	●	●	●	●	●	●	●	-	-
Attachments and Inserts												
ROT15-SC	Natural Roll Out Tray for 15" Space (2/pkg)	●	●	●	●	●	●	●	●	●	●	●
ROT18-SC	Natural Roll Out Tray for 18" Space (2/pkg)	●	●	●	●	●	●	●	●	●	●	●
ROT21-SC	Natural Roll Out Tray for 21" Space (2/pkg)	●	●	●	●	●	●	●	●	●	●	●
ROT24-SC	Natural Roll Out Tray for 24" Space (2/pkg)	●	●	●	●	●	●	●	●	●	●	●
ROT27-SC	Natural Roll Out Tray for 27" Space (2/pkg)	●	●	●	●	●	●	●	●	●	●	●
ROT30-SC	Natural Roll Out Tray for 30" Space (2/pkg)	●	●	●	●	●	●	●	●	●	●	●
ROT33-SC	Natural Roll Out Tray for 33" Space (2/pkg)	●	●	●	●	●	●	●	●	●	●	●
ROT36-SC	Natural Roll Out Tray for 36" Space (2/pkg)	●	●	●	●	●	●	●	●	●	●	●
LSK	Natural Lazy Susan Kit (2/pkg)	●	●	●	●	●	●	●	●	●	●	●
TCKK	Trash Can Insert for B18 with 2 35 QT Trash Cans	●	●	●	●	●	●	●	●	●	●	●
SRI9	Natural Spice Rack Insert for B9 Drawer	●	●	●	●	●	●	●	●	●	●	●
CDI14	Natural Cutlery Drawer Insert for B15/B18	●	●	●	●	●	●	●	●	●	●	●
CDI20	Natural Cutlery Drawer Insert for B21/B24	●	●	●	●	●	●	●	●	●	●	●
SRD12	Natural Spice Rack Door Mount for 18" Door	●	●	●	●	●	●	●	●	●	●	●
SRD15	Natural Spice Rack Door Mount for 21" Door	●	●	●	●	●	●	●	●	●	●	●
STI14	Natural Spice Tray Drawer Insert for B15/B18	●	●	●	●	●	●	●	●	●	●	●
STI20	Natural Spice Tray Drawer Insert for B21/B24	●	●	●	●	●	●	●	●	●	●	●
SWR3012	Stemware Rack	●	●	●	●	●	●	●	●	●	-	-
Miscellaneous Parts												
SHELF1296	Natural Shelf - 96" W x 12" D	●	●	●	●	●	●	●	●	●	●	●
SHELF1296	Painted/Stained Shelf - 96" W x 12" D	●	●	●	●	●	●	●	●	●	●	●
SHELF2496	Natural Shelf - 96" W x 24" D	●	●	●	●	●	●	●	●	●	●	●
GLZPEN	Glaze Pen	●	●	●	●	-	●	●	●	●	●	●
GLZBRUSH	Glaze Brush	●	●	●	●	-	●	●	-	●	●	●
SPRAYCAN	Aerosol Spray Can	●	●	●	●	●	●	●	●	●	●	●
TUKIT	Touch Up Kit	●	●	●	●	●	●	●	●	●	●	●
YN-PAB	Plastic Assembly Blocks (100/pkg)	●	●	●	●	●	●	●	●	●	●	●
YN-BRACKETS	Metal Assembly Bracket	●	●	●	●	●	●	●	●	●	●	●
YN-SOFTCLOSE	Soft Close Hinge	●	●	●	●	●	●	●	●	●	●	●
YN-ERHINGE-SET	Easy Reach Hinges (Set of 4)	●	●	●	●	●	●	●	●	●	●	●
YN-SOFTCLOSE-CW	Soft Close Corner Wall Hinge	●	●	●	●	●	●	●	●	●	●	●

[illegible]

NOTES:

This image shows a single sheet of white paper with horizontal ruling lines. The lines are evenly spaced and run across the width of the page. There are no margins, text, or other markings on the paper.

Servicing America

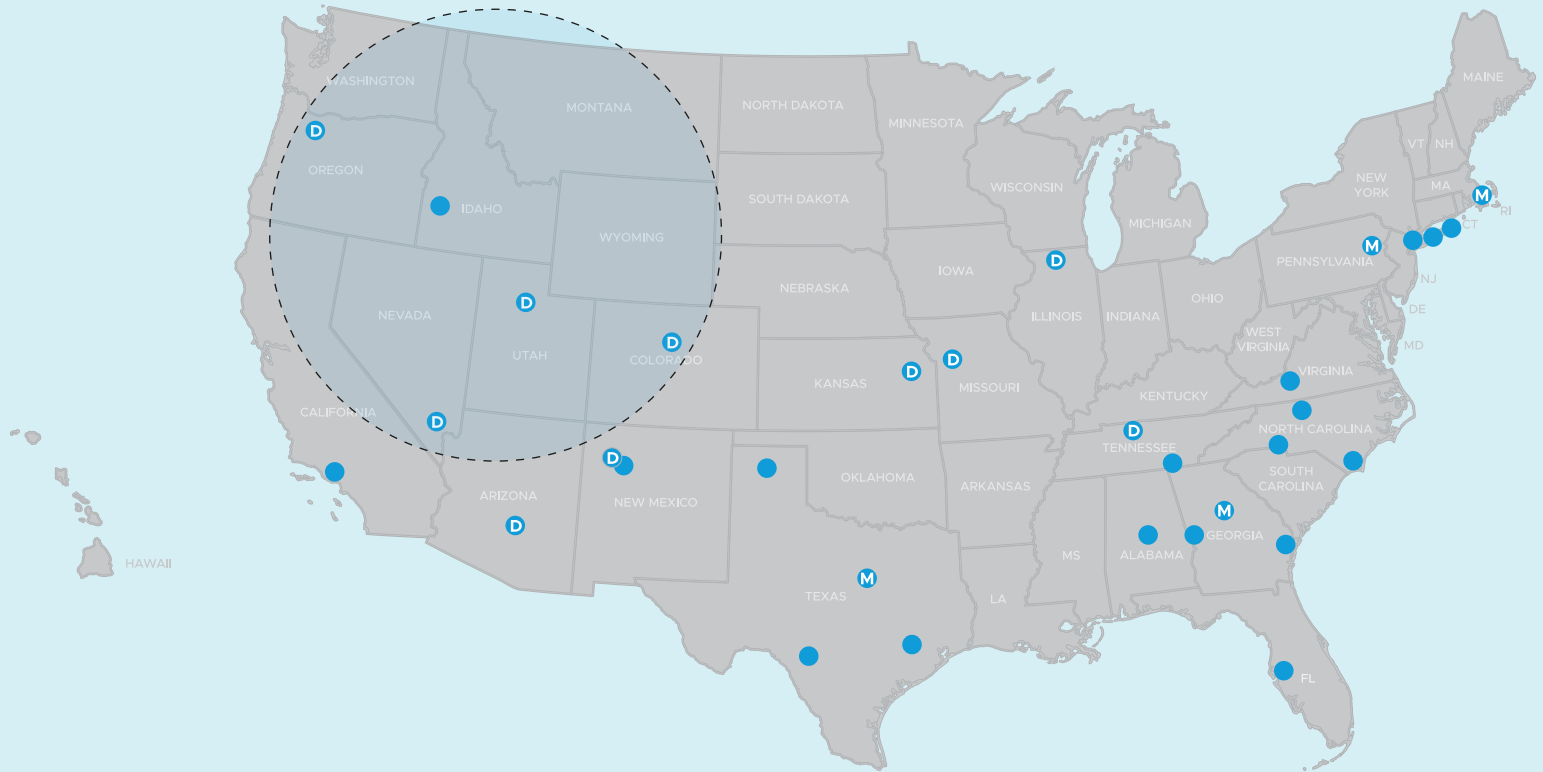

DOOR MANUFACTURING



MOULDING AND MILLWORK MANUFACTURING

MOUNTAIN AND PACIFIC NORTHWEST REGION

BOISE

12040 W. Executive Dr.
Boise ID, 83713
Tel: 208-336-3911
Tel: 855-571-9663
Fax: 208-345-8233

DENVER

4744 Forest St., Suite A
Denver, CO 80216
Tel: 303-296-7260
Tel: 800-736-3750
Fax: 303-296-8583

LAS VEGAS

4545 W. Diablo Dr., Suite B
Las Vegas, NV 89118
Tel: 702-248-0050
Tel: 800-488-2322
Fax: 702-248-0157

PORTLAND

29899 SW Boones
Ferry Road, Suite 300
Wilsonville, OR 97070
Tel: 503-692-3322
Tel: 800-926-7103
Fax: 503-691-5166

SALT LAKE CITY

2850 South 900 West
Salt Lake City, UT 84119
Tel: 801-972-9393
Tel: 800-388-9393
Fax: 801-972-0502

OTHER RUGBY LOCATIONS

Albuquerque, NM
505-924-2270

Chattanooga, TN
423-332-1377

Moonachie, NJ
201-807-9701

San Antonio, TX
210-657-5944

Amarillo, TX
806-352-2382

Columbus, GA
706-565-5337

Nashville, TN
615-885-0355

Savannah, GA
912-965-1061

Atlanta, GA
404-699-3900

Dallas, TX
214-638-5161

NY Metro – Bronx
718-589-9700

Tampa, FL
800-378-2016

Birmingham, AL
205-664-0224

Houston, TX
713-692-3388

NY Metro – Long Island
631-242-4369

Wilmington, NC
910-794-7225

Blakeslee, PA
570-646-6724

Kansas City, MO
816-531-0161

Olathe, KS
913-738-8074

Boston Metro – Stoughton
781-341-9255

Kernersville, NC
336-993-8686

Phoenix, AZ
602-252-3696

Charlotte, NC
704-494-0703

Los Angeles, CA
909-466-7315

Roanoke, VA
540-857-0425

Rugby®
Architectural Building Products

Toll-Free 1-855-650-3265

www.rugbyabp.com